

Specifically designed for **solar applications on a metal roofs**

Advanced Ozone Resistance tested to...		EPDM 70 hour @ 500 pphm	HIGH TEMP RED/GRAY SILICONE 70 hour @ 500 pphm
High Temperature Resistance Tested to	Intermittent	+135°C (+275°F)	+260°C (+500°F)
	Continuous	+100°C (+212°F)	+225°C (+437°F)
Low Temperature Resistance tested to...		- 55°C (-67°F)	- 74°C (-101°F)
Compression Set Maximum...		25%	50%

*Complete specification data and testing methods are available upon request.

The simple round base flashing is available with a pre-cut hole for pipe sizes 3/4" to 1" (19 - 25mm) allowing for minimal on-site preparation and assembly.



Weather Protection

Made of EPDM or High Temp Red Silicone,

These flashings are compounded specifically for maximum resistance to weathering due to ozone and ultraviolet light.

Unique compression seal technology

Adaptable Base

The base is designed to mold to most panel configurations and roof pitches regardless of pipe location.

The pitch canal allows for maximum flexibility, easily accommodating up to a 60° degree pitch without affecting performance.

Easy on-site customization accommodates all normal installations.

Sleeve flexibility absorbs vibration and pipe movement caused by expansion/contraction

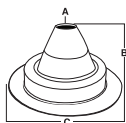
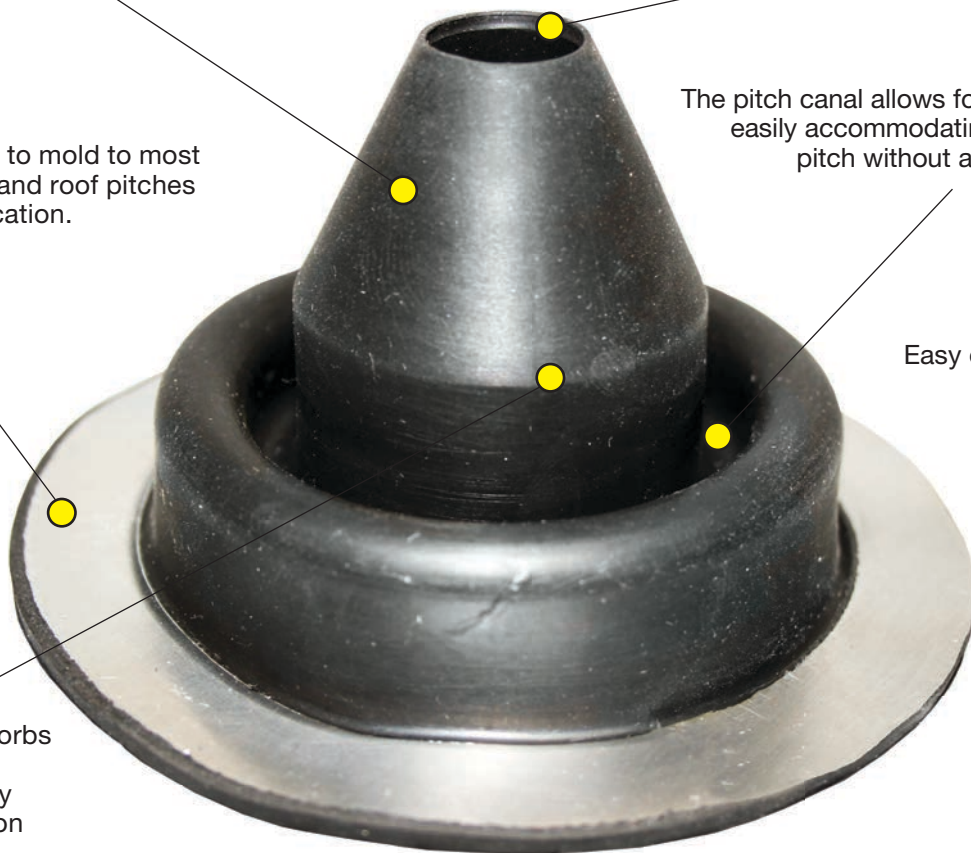

Solar Flash Flashing Details

A-Top Opening	3/4" - 1-1/8" (19-28mm)
B-Overall Height	2-1/4" (57mm)
C-Base	4" (101mm)

Name Part # Compound Pipe Range Base

Solar Flash	SF101BA	Black EPDM	3/4" - 1-1/8" (19 - 28mm)	4" (101mm)
	SF102RA	Red Silicone		
	SF102GX	Gray Silicone		

Solar Flash Master Flash®

Solar Flash Size and Trimming

Solar Flash Pipe Range

Solar Flash

1 3/4" - 1-1/8" (19-28mm)

1 3/4" - 1-1/8" (19-28mm)

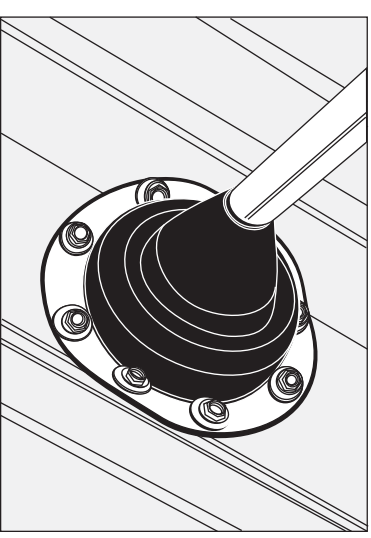
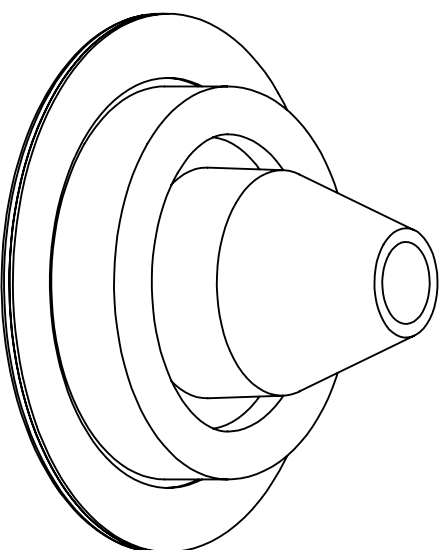

* Note This is the Solar For Reference

**Base Dimension: Solar Flash 4" (101mm)

* Find pipe size in table and trim Solar Flash Master Flash® as shown on outline. * Cut the flashing at least 20% less then the pipe Outer Diameter

5 Easy Steps Installation Materials: Solar Flash Master Flash® | Fasteners | Washers | Snips/Scissors | Measuring Tape | Marker/Pencil | Sealant

Measure & Trim

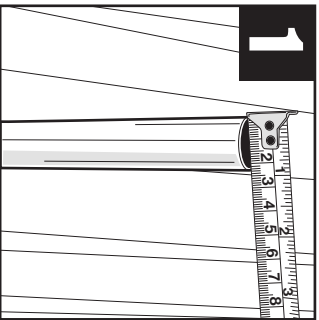

Slide

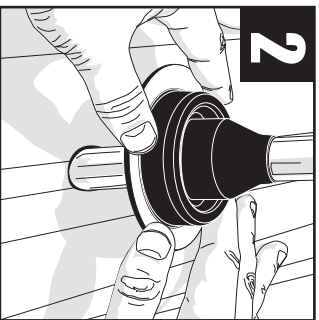

Form

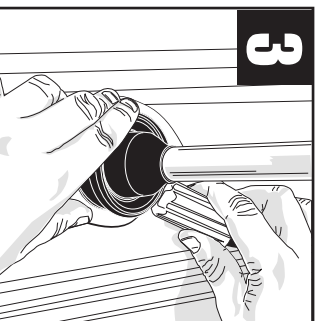

Seal

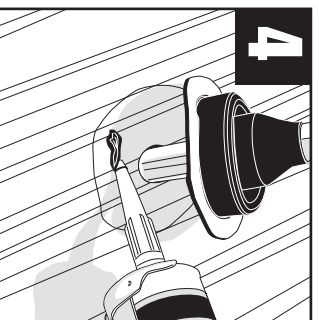

Complete

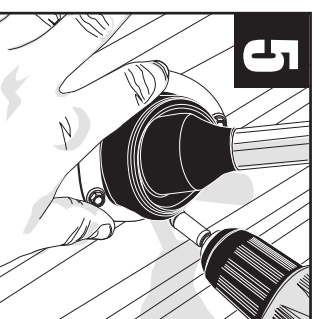

Note: Properly installed the base with Master Seal® Bonded Washers and fasteners. Fasteners should be 1" - 1-1/2" apart around the entire base for a tight secure seal.



Installation Video: <http://www.aztecwasher.com/installationvideos>

Solar Flash Master Flash® is a product of Aztec Washer Company 5/2023



Installation Guides